

Reference : C-BSO28H32 8-FT-28FR F-NG

The Fixolite box is a 6 m long prefabricated lintel box designed to receive a closure (roller shutter, BSO, etc.). The box consists of an inverted U-shaped, fire-retardant expanded polystyrene (30 kg/m³ density) shell reinforced with steel mesh. The side walls are fitted with aluminum rails.

Orientable Sun Shade model box. This box is specially adapted for BSOs. Its cutaway allows it to accommodate the largest shutters and to fix it on its central rail. The box is certified by Technical Advice to the CSTB.

| | |
|--|--|
| Type | BSO28H32 |
| Outer rail ref. | 827 |
| Inner rail ref. | 28FR |
| Finishing | Wood-cement fiber |
| Color | Grey graphitized polystyrene |
| Compatible cheek | J-BSO |
| Certification | CSTB 16-11-634 (translated) |
| Thermal conductivity | U = 0.39 W/m ² .K |
| Thermal resistance* | R = 2.54 m ² .K/W |
| (*) R: thermal resistance (m ² .K/W) taking into account a λ coefficient of 0.0374 W/m.K after application of a safety coefficient of 1.15. | |
| Weight | 5.3 kg/m |
| Reaction to fire | class E (EN ISO 11925-2/EN 13 501) |
| Air permeability | c*3 class |
| Acoustic perf. (Dn _W) | 58 dB |

Components

| | |
|---------------------------|-----------------|
| Aluminium (recycl. 85%) | 1.54 kg/m |
| Steel (recycl. 96.5%) | 1.1 kg/m |
| Polystyrene (recycl. 10%) | 1.51 kg/m |
| Wood-cement fiber | 1.15 kg/m |
| Total | 5.3 kg/m |

Finishing (Wood-cement fiber)



Box dimensions

| | |
|---------------|--------|
| Width | 280 mm |
| Height | 320 mm |
| Tunnel | 140 mm |
| External side | 95 mm |
| Internal side | 45 mm |

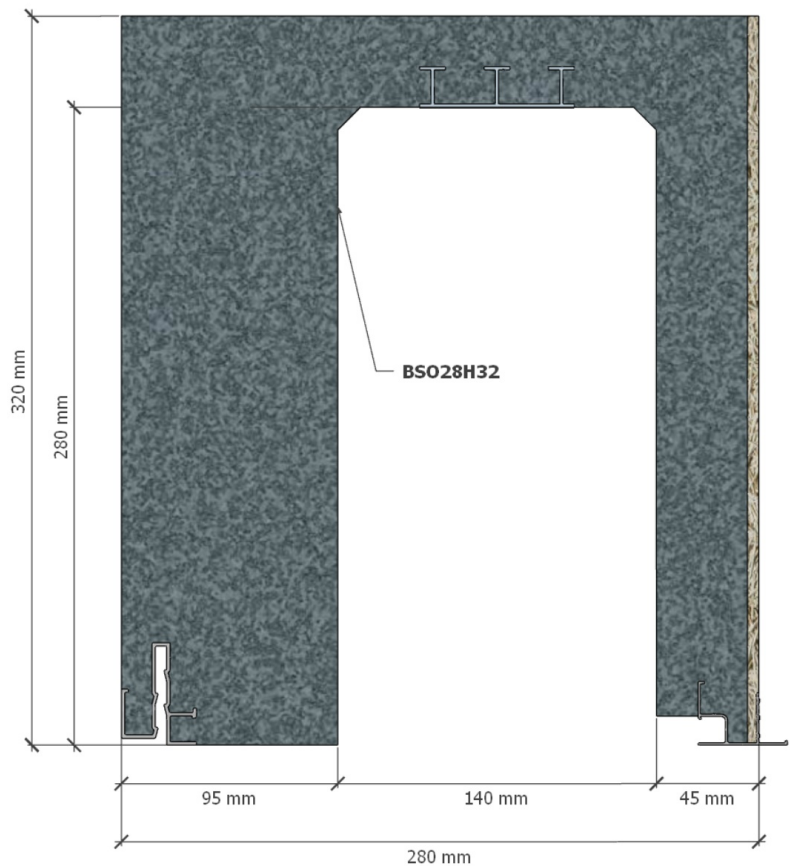

Box shown: C-BSO28H32 8-FX-28FR F-NG

Rail diagram

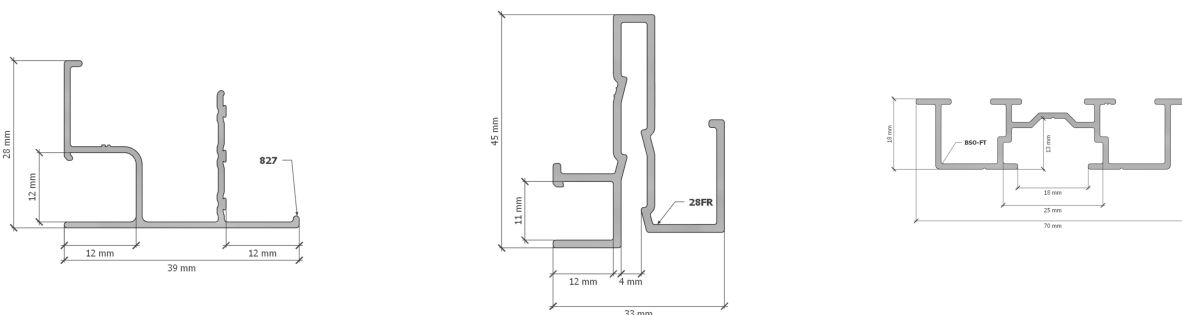

English version:

https://fixolite.eu/doc/C-BSO28H32_8-FT-28FR_F-NG.en.pdf



Version française:

https://fixolite.eu/doc/C-BSO28H32_8-FT-28FR_F-NG.fr.pdf