

Reference : C-30H30 8-8H F-NB

The Fixolite box is a 6 m long prefabricated lintel box designed to receive a closure (roller shutter, BSO, etc.). The box consists of an inverted U-shaped, fire-retardant expanded polystyrene (30 kg/m³ density) shell reinforced with steel mesh. The side walls are fitted with aluminum rails.

Traditional model box. This box is the most economical and offers good performance. The box is certified by Technical Advice to the CSTB.

Type	30H30
Outer rail ref.	827
Inner rail ref.	8H
Finishing	Wood-cement fiber
Color	Blue polystyrene
Compatible cheek	J-30
Certification	CSTB 16-11-634 (translated)

Thermal conductivity U = 1.43 W/m².KThermal resistance* R = 0.7 m².K/W

(*): R: thermal resistance (m².K/W) taking into account a λ coefficient of 0.0374 W/m.K after application of a safety coefficient of 1.15.

Weight	3.22 kg/m
Reaction to fire	class E (EN ISO 11925-2/EN 13 501)
Air permeability	c*3 class
Acoustic perf. (Dn _w)	49 dB

Components

Aluminium (recycl. 85%)	0.56 kg/m
Steel (recycl. 96.5%)	0.76 kg/m
Polystyrene (recycl. 10%)	0.71 kg/m
Wood-cement fiber	1.19 kg/m
Total	3.22 kg/m

Finishing (Wood-cement fiber)**Box dimensions**

Width	298 mm
Height	295 mm
Tunnel	246 mm
External side	26 mm
Internal side	26 mm

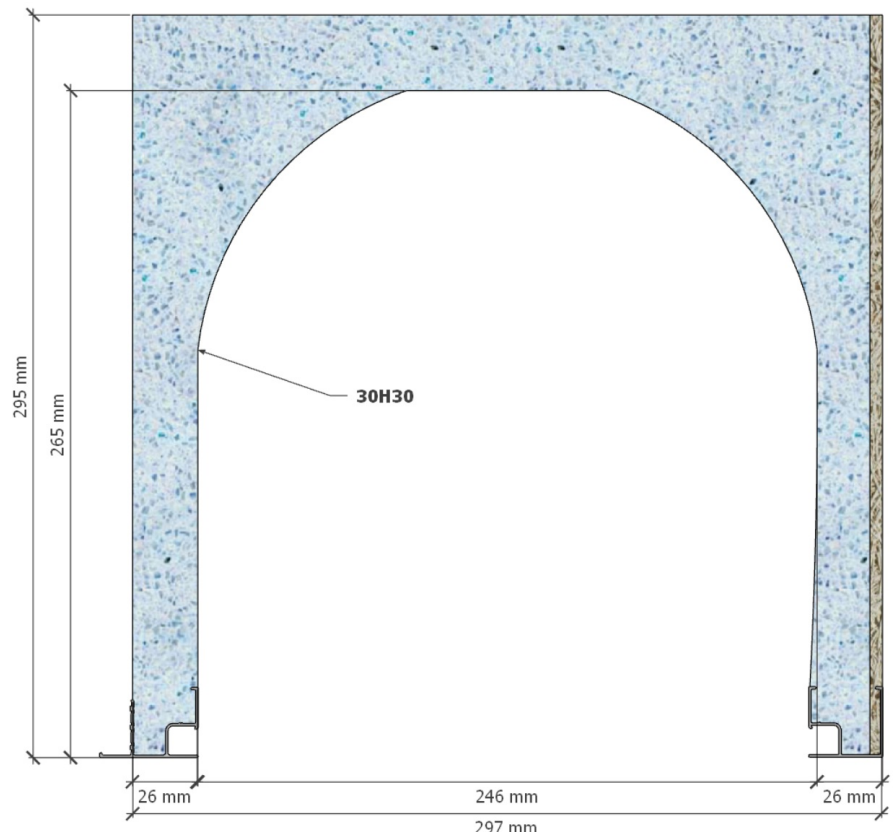
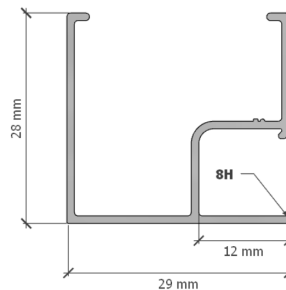
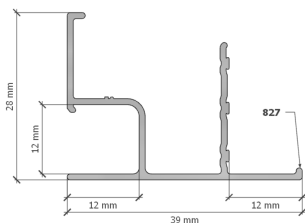
**Rail diagram****English version:**
https://fixolite.eu/doc/C-30H30_8-8H_F-NB.en.pdf
**Version française:**
https://fixolite.eu/doc/C-30H30_8-8H_F-NB.fr.pdf

2024-04 • **Fixolite Disclaimer.** The information provided in this technical sheet is for reference only and without warranty of accuracy or completeness. Fixolite disclaims any liability for errors, omissions, or consequences related to the use of this information. Specifications are subject to change without notice.